

KIT DI CONNESSIONE DISPONIBILI

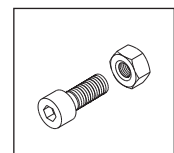
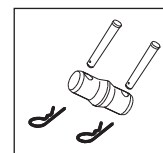

CARATTERISTICHE

Dimensioni esterne	292 mm x 52 mm
Interasse	239 mm
Tubi correnti	Tubo tondo Ø 50x2 mm Alluminio EN AW 6082-T6
Tubi diagonali	Tubo tondo Ø 20x2 mm Alluminio EN AW 6060-T6
Flange	Fusione in Alluminio
Sistema di connessione	Set giunti con spine coniche e copiglie / bulloni (a richiesta)

MODULI STANDARD

LUNGH. (m)	0.21	0.50	1.00	1.50	2.00	2.50	3.00	3.50	4.00
PESO (kg)	-	2.5	3.8	5.0	6.2	7.5	8.7	9.9	11.0

Carichi (con giunti e spine)	CPL		2PL		3PL		4PL		UDL		Freccia Centrale Max.(cm)
	↓	↓	↓ ↓	↓ ↓ ↓	↓ ↓ ↓ ↓	↓ ↓ ↓ ↓ ↓	↓ ↓ ↓ ↓ ↓ ↓	↓ ↓ ↓ ↓ ↓ ↓ ↓ ↓	↓ ↓ ↓ ↓ ↓ ↓ ↓ ↓ ↓ ↓		
Lunghezza	↓	↓	↓ ↓	↓ ↓	↓ ↓	↓ ↓	↓ ↓	↓ ↓	Carico Distribuito (kg/m)	Carico totale (kg)	
4 m	220	171	342	114	342	95	380	110	440	0.9	
6 m	145	117	234	78	234	65	260	48	288	2.1	
8 m	105	90	180	60	180	50	200	26	208	3.8	
10 m	80	75	150	50	150	42	168	16	160	6.2	
12 m	64	68	136	45	135	38	152	11	132	9.6	