

KIT DI CONNESSIONE DISPONIBILI

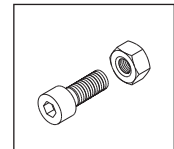
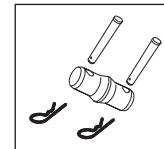

CARATTERISTICHE

Dimensioni esterne	250mm x 225 mm
Interasse	200 mm
Tubi correnti	Tubo tondo Ø 50x2 mm Alluminio EN AW 6060-T6
Tubi diagonali	Tubo tondo Ø 12x1.5 mm Alluminio EN AW 6060-T6
Flange	Fusione in Alluminio
Sistema di connessione	Set giunti con spine coniche e copiglie / bulloni (a richiesta)

MODULI STANDARD

LUNGH. (m)	0.125	0.25	0.50	1.00	1.50	2.00	2.50	3.00	4.00
PESO (kg)	-	-	3.36	5.13	6.9	8.67	10.43	12.2	15.74

Carichi (con giunti e spine)	CPL		2PL		3PL		4PL		UDL		Freccia Centrale Max.(cm)
	↓	↓	↓ ↓	↓ ↓ ↓	↓ ↓ ↓ ↓	↓ ↓ ↓ ↓ ↓	↓ ↓ ↓ ↓ ↓ ↓	Carico Distribuito (kg/m)	Carico totale (kg)		
Lunghezza	↓	↓	↓ ↓	↓ ↓ ↓	↓ ↓ ↓ ↓	↓ ↓ ↓ ↓ ↓	↓ ↓ ↓ ↓ ↓ ↓				
4 m	246	184	368	123	369	102	408	123	492	1.0	
6 m	157	118	236	79	237	65	260	52	312	2.2	
8 m	111	83	166	55	165	46	184	28	224	4.0	
10 m	81	61	122	41	123	34	136	16	160	6.0	
12 m	61	45	90	30	90	25	100	10	120	8.7	