

PROFESSIONAL HD 40X56

GENERAL FEATURES

Aluminium 6082-T6 alloy Truss, main tube \varnothing 50 x 3 mm, diagonal tube \varnothing 25 x 2 mm.

It can contain Euro 29, SuperLite 25, Elite 25, and Standard linear trusses.

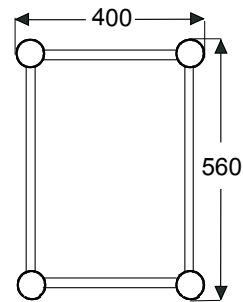
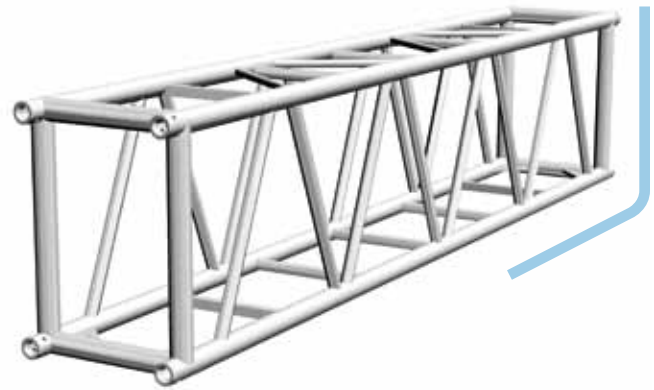

| CODE | WEIGHT | TRUSS DESCRIPTION |
|---------|----------|---|
| TB 9106 | 20,70 kg | Professional HD 40 x 56 Truss - 2,5 m (4 TB 4000 included) |
| TB 9108 | 24,07 kg | Professional HD 40 x 56 Truss - 3,0 m (4 TB 4000 included) |
| CODE | WEIGHT | ACCESSORIES DESCRIPTION |
| TB 9206 | 3,70 kg | Aluminium sliding bar for 6 Light Par 64 (2,5 m) (rectangular tube 60x40 mm) (with 2 guiding sticks and clips) |
| TB 9208 | 3,90 kg | Aluminium sliding bar for 6 Light Par 64 (3 m) (rectangular tube 60x40 mm) (with 2 guiding sticks and clips) |
| TB 9201 | 0,98 kg | Kit: 4 wheels \varnothing 50 mm |

| TRUSS LENGTH | POINT LOAD KG | DISTRIBUTED LOAD KG/M |
|--------------|---------------|-----------------------|
| | ▲ | ▲▲▲▲▲ |
| 4 m | 2500 | 800 |
| 6 m | 2132 | 711 |
| 8 m | 1564 | 391 |
| 10 m | 1215 | 243 |
| 12 m | 976 | 163 |
| 14 m | 799 | 114 |
| 16 m | 662 | 83 |
| 18 m | 551 | 61 |
| 20 m | 458 | 46 |

LOADING FIGURES

ACCESSORIES:

TB 9201
Kit: 4 wheels 50 mm

