

**AVAILABLE CONNECTION SYSTEMS**

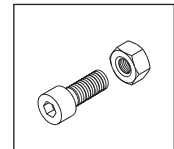

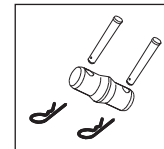



### TECHNICAL SPECIFICATIONS

External dimensions	250mm x 225 mm
Interaxis	200 mm
Main tube	Round tube Ø 50x2 mm Aluminium EN AW 6082-T6
Diagonal tube	Round tube Ø 12x1.5 mm Aluminium EN AW 6060-T6
Endplate	Aluminium casting
Coupling set	Conical spigots, pins and clips (standard) / Bolts (on request)

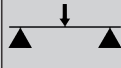
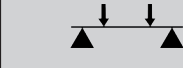
### STANDARD LENGTHS

LENGTH (m)	0.125	0.25	0.50	1.00	1.50	2.00	2.50	3.00	4.00
WEIGHT (kg)	-	-	3.36	5.13	6.9	8.67	10.43	12.2	15.74

Loading distribution WITH SPIGOTS	CPL		2PL		3PL		4PL		UDL		
											
Length	↓	↓	↓↓	↓	↓↓	↓	↓↓	U.D.L. (kg/m)	Total load weight (kg)	Max central Deflection (cm)	
4 m	246	184	368	123	369	102	408	123	492	1.0	
6 m	157	118	236	79	237	65	260	52	312	2.2	
8 m	111	83	166	55	165	46	184	28	224	4.0	
10 m	81	61	122	41	123	34	136	16	160	6.0	
12 m	61	45	90	30	90	25	100	10	120	8.7	